

Improved replacement / alternative to legacy solenoids and remote battery switches. Wire for wire compatible with Blue Sea ML-solenoid and ML-remote battery switch products.

Heavy Duty 500 Amp Continuous Capability

Available with or Without Intuitive Front Facing Manual Override Knob with Ability to Lock Device ON or OFF for Servicing

Local and remote LED Indicators for ease of mounting in hard to reach places

Extremely compact footprint, uses 40% less space than legacy devices

Forward facing input studs make landing large wires easy and protective cover with integrated label recesses enables easy identification while providing anti-contact short protection

**PATENT
PENDING**

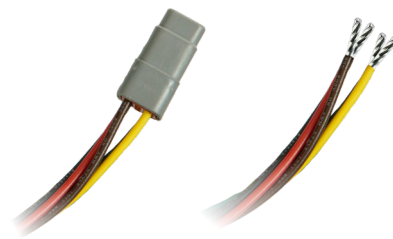
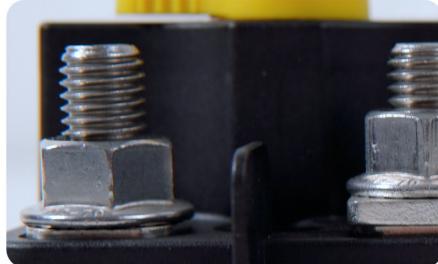

Diagnostic Feedback via optional external led and on-board LEDs



Bullet-proof Construction: Sealed unit, high temperature materials allow mounting anywhere on vehicle. Integrated thermal overload protection



Meets Stringent OEM Standards for electrical transient self-protection



4 Year Industry Leading Warranty



Simple & Robust Installation: Sealed plug/harness included.

Dip Switch Setting Options & Features

*** DISCONNECT BATTERY FROM POWER DISTRIBUTION SYSTEM BEFORE INSTALLING PRODUCT TO PREVENT ELECTRICAL SHOCK OR PRODUCT DAMAGE**

DIP SWITCH ON BOTTOM OF DEVICE

ON
OFF

1 6

DS1 sets single or dual input control. Dual mode is for separate +Vdc inputs for OFF (green wire) and ON (brown wire) Single mode is for +Vdc ON (red wire) and floating / Gnd (red wire) for OFF

If replacing legacy competitive ML Latching Relays from Blue Sea Systems, DS1 will be set to match the functionality of the legacy device.

| Dual / Single Input Control Selection | |
|---------------------------------------|--|
| 1 | |
| DUAL | Brown = On Green = Off (Use +Vdc) |
| SINGLE | Use Red Wire +Vdc = On Float or Gnd = Off |

| Remaining Dip Switches | |
|------------------------|--|
| 2 3 4 5 6 | |
| NOT USED | |

Factory Default

Dimensions

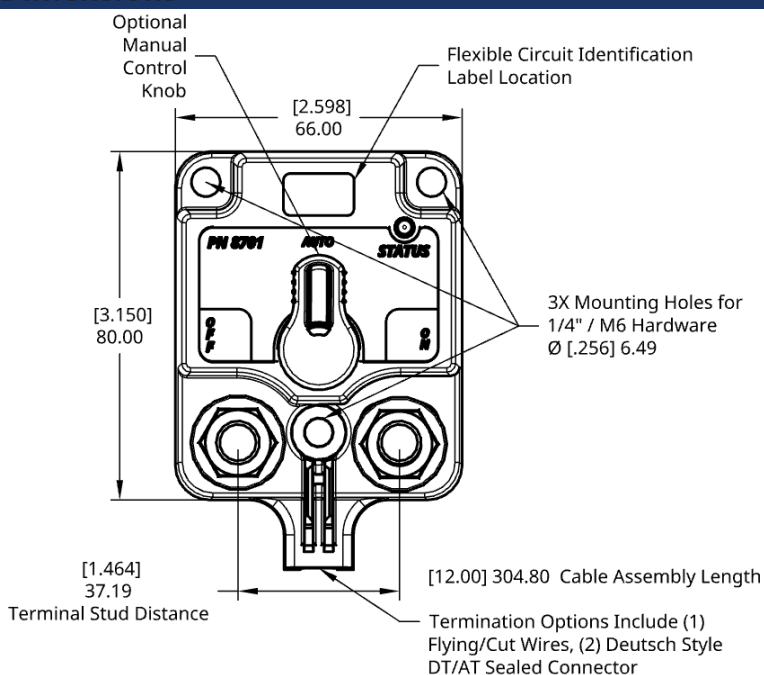

2X M10 x 1.5 Stainless Steel High Power I/O Terminals & Serrated Flange Nuts.

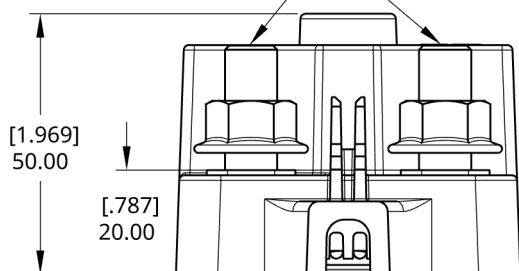

* Custom product configurations available including control harness wires, time delays, voltage settings, dip switch functionality, and control input functionality. Low minimum quantities and short lead time for samples or production. Contact support@egismobile.com

System Diagram

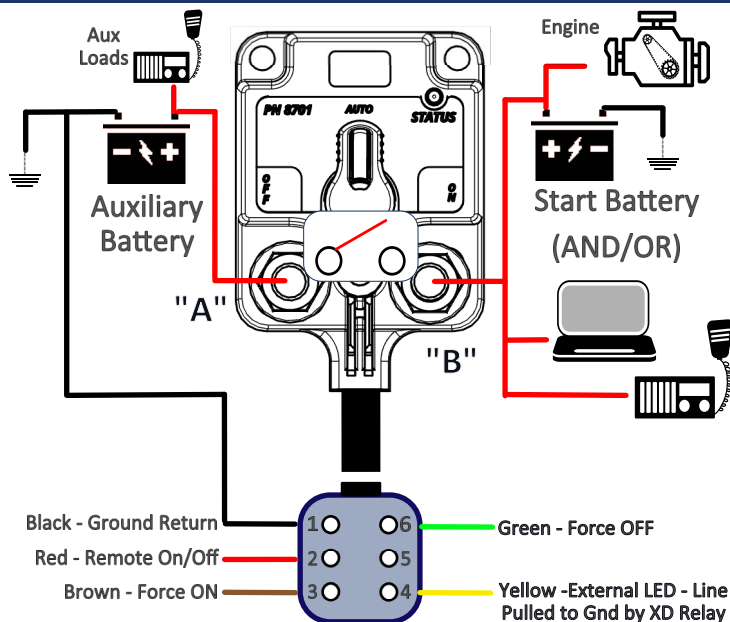

DTM 06-6S Connector End. Customer Supplies
DTM04-6P or Cuts & Uses Individual Wire Terminations

Specifications

| | | |
|---------------------------------------|------------------------------|----------|
| Input Voltage Range (Vdc) | 8.0 - 36.0 Auto-Ranging | |
| Nominal Voltage (Vdc) | 12 | 24 |
| V_Close Voltage Trigger (Vdc) | 13.1 | 26.2 |
| V_Open Voltage Trigger (Vdc) | 12.7 | 24.4 |
| Over Voltage Protection (Vdc) (5 sec) | 17.0 | 34.0 |
| State Change Current (20 msec) | 5.0 A | 3.0 A |
| Standby Current (mA) | 1.3 | 1.3 |
| Live Current Switching -50,000 cycles | 12V/300A | 24V/300A |
| Mechanical Switching Life | 1,000,000 cycles | |
| 2/0 AWG - 30sec/5min/Continuous | 1000 / 400 / 225 Amps | |
| 4/0 AWG - 30sec/5min/Continuous | 1100 / 400 / 300 Amps | |
| 2x 4/0 AWG - 30sec/5min/Cont. | 1600 / 700 / 500 Amps | |
| Hardware Material | Stainless Steel Self-Locking | |
| Terminal Stud Torque | 120 in-lbs | |
| LED/Aux Output Max Drive Current | 400 milli-Amps | |
| Min Source Current for Inputs | 10 micro-Amps | |

Part Numbers Knob Connection Resell Pack Bulk Pack

| | | | | |
|------------------------------|-----|-------------|-----------|------------|
| XD Battery Disconnect Switch | Yes | Tinned Wire | 8710-1500 | 8710-1500B |
| XD Battery Solenoid | No | Tinned Wire | 8710-1600 | 8810-1600B |
| XD Battery Disconnect Switch | Yes | Deutsch DTM | 8810-1500 | 8710-1500B |
| XD Battery Solenoid | No | Deutsch DTM | 8801-1600 | 8810-1600B |

Related Products Knob Resell Pack Bulk Pack

| | | | |
|---------------------------------|-----|-----------|------------|
| XD Flex Relay/ACR / LVD | Yes | 8710-1100 | 8710-1100B |
| XD Flex Relay/ACR / LVD | No | 8710-1200 | 8710-1200B |
| XD Flex Relay/ACR / LVD | Yes | 8810-1100 | 8810-1100B |
| XD Flex Relay/ACR / LVD | No | 8810-1200 | 8810-1200B |
| XD Automatic Charging Relay ACR | Yes | 8710-1300 | 8710-1300B |



www.egismobile.com
360.768.1211
Bellingham, WA U.S.A



XD Battery Disconnect - Competitor Comparison / Cross Reference



Product Comparison Summary

| Feature/Specification | XD Series ACR | ML-ACR |
|-----------------------------------|--------------------|-------------------------|
| Universal 12/24 Control Voltage | Yes | No, 12 or 24 Vdc |
| Cover for Power Terminals | Included | No |
| Function & Cable Label Sheet | Included | Not Included |
| Local Status Led Indicator | Yes | No |
| Ability to Manually Lock On | Yes | No |
| Intuitive Manual Override | Yes | No |
| Terminal Stud Material | Stainless | Copper ⁽²⁾ |
| Simple Bottom Cable Entry | Yes | No ⁽³⁾ |
| Product Assemblies for 2-7 Relays | Yes ⁽⁵⁾ | No |
| Dust & Water IP Rating | IP67 / IP6K9K | IP66 ⁽⁴⁾ |
| Pressure Regulated Enclosure | Yes | No |
| Marine Grade Control Wiring | Yes | No |
| Mounting Footprint Width | 66 ⁽⁶⁾ | 95 |
| Mounting Footprint Length | 80 ⁽⁶⁾ | 140 |
| Mounting Depth | 50 | 51.5 |
| Standby Current Draw | 1.2 mA | 0 - 8 mA ⁽¹⁾ |
| Max Continuous Current | 500 A | 500 A |
| Power Input Stud Size | M10 (3/8") | 3/8" (M10) |

(1) Excessive standby current drains batteries as no charge source is present potentially permanently damaging batteries and voiding battery warranties. The XD Series Standby current is 70% lower than the competitor's auto-release version, and so low (1.2 mA) that on its own would take 9 years to drain a Group 31 battery.

(2) Copper terminal studs in general are susceptible to thread damage if excessive assembly torque on the attachment nut is applied. The result is stripping of the threads and spinning of the nut; and a reduction or loss of clamping force between the cable terminal and device terminal. This can result in increased resistance and possibly overheating of the device and power cables.

(3) Studs parallel to the mounting surface require right angle cable terminal lugs to achieve bottom cable entry

(4) IP67 and IP6K9K are standard marine / harsh environment ingress performance levels to ensure effective long-term performance

(5) XD Series products are also available in single housing double and triple relay versions which provide significant cost, space, and standby current draw benefits versus existing industry options.

(6) XD Series mounting footprint is 60% smaller and much lighter, critical in today's systems with very limited space allocated for power management and where the affect of total system weight on vessel / vehicle performance has received greater attention.

High Ampere Remote Battery Switches

| Blue Sea Sys P/N | Vdc | Egis Mobile Electric P/N | Vdc | Manual Control | Control Leads | Control Method ⁽¹⁾ |
|------------------|-----|--------------------------|-------|----------------|---------------|-------------------------------|
| 7700 | 12 | 8710-1500B | 12/24 | Yes | Wires | Bi-Stable |
| 7700100 | 12 | 8810-1500B | 12/24 | Yes | DTM | Bi-Stable |
| 7702 | 24 | 8710-1500B | 12/24 | Yes | Wires | Bi-Stable |
| 7702100 | 24 | 8810-1500B | 12/24 | Yes | DTM | Bi-Stable |
| 7713 | 12 | 8710-1500B | 12/24 | Yes | Wires | Auto-Release |
| 7713100 | 12 | 8810-1500B | 12/24 | Yes | DTM | Auto-Release |
| 7717 | 24 | 8710-1500B | 12/24 | Yes | Wires | Auto-Release |
| 7717100 | 24 | 8810-1500B | 12/24 | Yes | DTM | Auto-Release |

(1) Control Method Determined by Dip Switch Selection on Device

High Ampere Solenoids

| Blue Sea Sys P/N | Vdc | Egis Mobile Electric P/N | Vdc | Manual Control | Control Leads | Control Method ⁽²⁾ |
|------------------|-----|--------------------------|-------|----------------|---------------|-------------------------------|
| 7701 | 12 | 8710-1600B | 12/24 | No | Wires | Bi-Stable |
| 7701100 | 12 | 8810-1600B | 12/24 | No | DTM | Bi-Stable |
| 7703 | 24 | 8710-1600B | 12/24 | No | Wires | Bi-Stable |
| 7703100 | 24 | 8810-1600B | 12/24 | No | DTM | Bi-Stable |
| 7718 | 12 | 8710-1600B | 12/24 | No | Wires | Auto-Release |
| 7718100 | 12 | 8810-1600B | 12/24 | No | DTM | Auto-Release |
| 7719 | 24 | 8710-1600B | 12/24 | No | Wires | Auto-Release |
| 7719100 | 24 | 8810-1600B | 12/24 | No | DTM | Auto-Release |

(2) Control Method Determined by Dip Switch Selection on Device

High Amp Automatic Charging Relays (ACRs)

| Blue Sea Sys P/N | Vdc | Egis Mobile Electric P/N | Vdc | Manual Control | Control Leads |
|------------------|-----|--------------------------|-------|----------------|---------------|
| 7620 | 12 | 8710-1400B | 12/24 | No | Wires |
| 7620100 | 12 | 8810-1400B | 12/24 | No | DTM |
| 7621 | 24 | 8710-1400B | 12/24 | No | Wires |
| 7621100 | 24 | 8810-1400B | 12/24 | No | DTM |
| 7622 | 12 | 8710-1300B | 12/24 | Yes | Wires |
| 7622100 | 12 | 8810-1300B | 12/24 | Yes | DTM |
| 7623 | 24 | 8710-1300B | 12/24 | Yes | Wires |
| 7623100 | 24 | 8810-1300B | 12/24 | Yes | DTM |

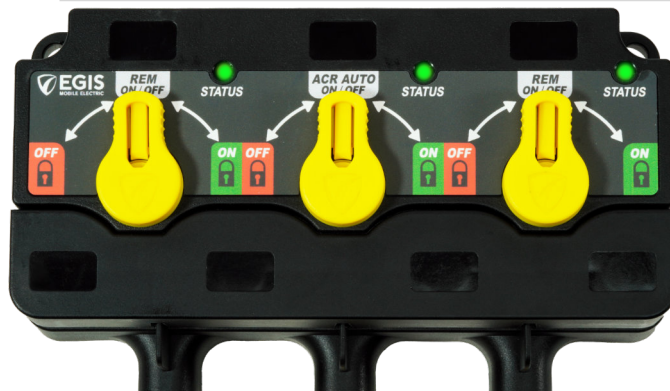

* XD Series Dual and Triple Relays can be configured to have each individual internal relay replicate legacy competitor product functionality and connect with external controls with the same DTM connector and pin-out locations, simplifying product transition.