

**Improved replacement / alternative to legacy solenoids and remote battery switches. Wire for wire compatible with Blue Sea ML-solenoid and ML-remote battery switch products.**

**Heavy Duty 500 Amp Continuous Capability**

**Available with or Without Intuitive Front Facing Manual Override Knob with Ability to Lock Device ON or OFF for Servicing**

**Local and remote LED Indicators for ease of mounting in hard to reach places**

**Extremely compact footprint, uses 40% less space than legacy devices**

**Forward facing input studs make landing large wires easy and protective cover with integrated label recesses enables easy identification while providing anti-contact short protection**

**PATENT  
PENDING**

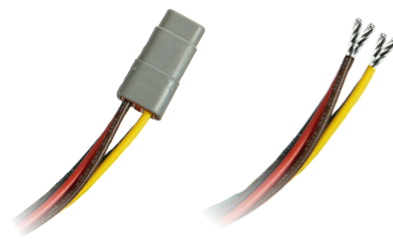
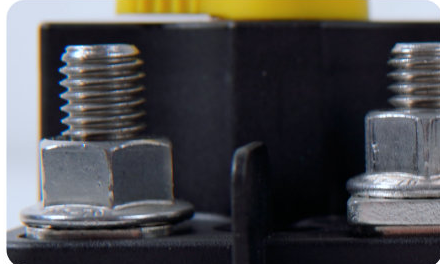

**Diagnostic Feedback** via optional external led and on-board LEDs



**Bullet-proof Construction:** Sealed unit, high temperature materials allow mounting anywhere on vehicle. Integrated thermal overload protection



**Meets Stringent OEM Standards** for electrical transient self-protection



**4 Year Industry Leading Warranty**



**Simple & Robust Installation:** Sealed plug/harness included.

## Dip Switch Setting Options & Features

**\* DISCONNECT BATTERY FROM POWER DISTRIBUTION SYSTEM BEFORE INSTALLING PRODUCT TO PREVENT ELECTRICAL SHOCK OR PRODUCT DAMAGE**

DIP SWITCH ON BOTTOM OF DEVICE

ON  
OFF

1 6

DS1 sets single or dual input control. Dual mode is for separate +Vdc inputs for OFF (green wire) and ON (brown wire) Single mode is for +Vdc ON (red wire) and floating / Gnd (red wire) for OFF

If replacing legacy competitive ML Latching Relays from Blue Sea Systems, DS1 will be set to match the functionality of the legacy device.

Dual / Single Input Control Selection	
1	
DUAL	Brown = On Green = Off (Use +Vdc)
SINGLE	Use Red Wire +Vdc = On Float or Gnd = Off

Remaining Dip Switches	
2 3 4 5 6	
NOT USED	

Factory Default

## Dimensions

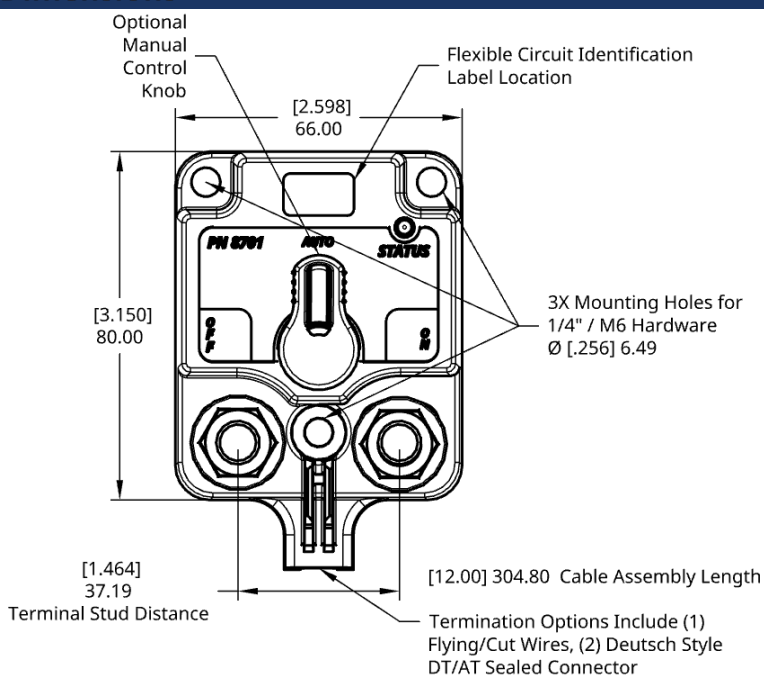

2X M10 x 1.5 Stainless Steel High Power I/O Terminals & Serrated Flange Nuts.

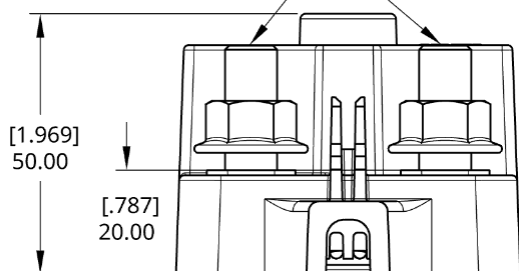

\* Custom product configurations available including control harness wires, time delays, voltage settings, dip switch functionality, and control input functionality. Low minimum quantities and short lead time for samples or production. Contact support@egismobile.com

## System Diagram

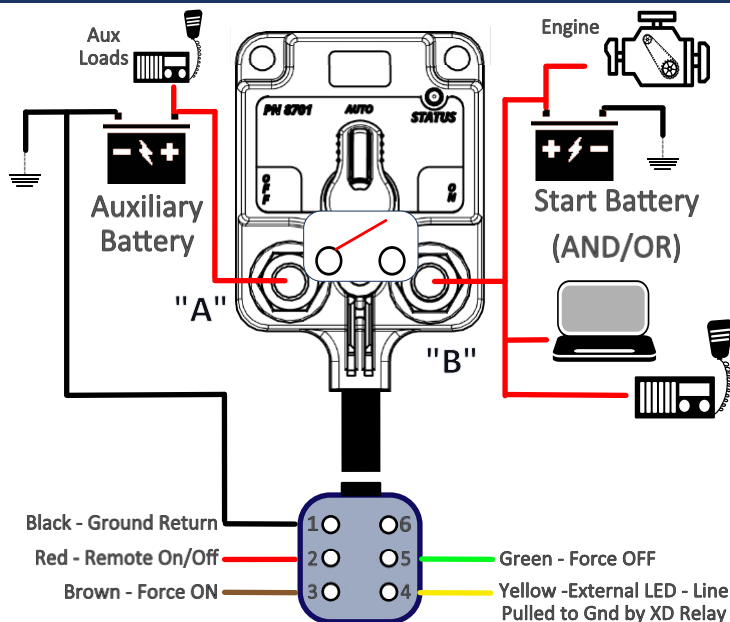

DTM 06-6S Connector End. Customer Supplies  
DTM04-6P or Cuts & Uses Individual Wire Terminations

## Specifications

Input Voltage Range (Vdc)	8.0 - 36.0 Auto-Ranging	
Nominal Voltage (Vdc)	12	24
V_Close Voltage Trigger (Vdc)	13.1	26.2
V_Open Voltage Trigger (Vdc)	12.7	24.4
Over Voltage Protection (Vdc) (5 sec)	17.0	34.0
State Change Current (20 msec)	5.0 A	3.0 A
Standby Current (mA)	1.3	1.3
Live Current Switching -50,000 cycles	12V/300A	24V/300A
Mechanical Switching Life	1,000,000 cycles	
2/0 AWG - 30sec/5min/Continuous	1000 / 400 / 225 Amps	
4/0 AWG - 30sec/5min/Continuous	1100 / 400 / 300 Amps	
2x 4/0 AWG - 30sec/5min/Cont.	1600 / 700 / 500 Amps	
Hardware Material	Stainless Steel Self-Locking	
Terminal Stud Torque	120 in-lbs	
LED/Aux Output Max Drive Current	400 milli-Amps	
Min Source Current for Inputs	10 micro-Amps	

## Part Numbers Knob Connection Resell Pack Bulk Pack

XD Battery Disconnect Switch	Yes	Tinned Wire	8710-1500	8710-1500B
XD Battery Solenoid	No	Tinned Wire	8710-1600	8810-1600B
XD Battery Disconnect Switch	Yes	Deutsch DTM	8810-1500	8710-1500B
XD Battery Solenoid	No	Deutsch DTM	8801-1600	8810-1600B

## Related Products

	Knob	Resell Pack	Bulk Pack
XD Flex Relay/ACR / LVD	Yes	8710-1100	8710-1100B
XD Flex Relay/ACR / LVD	No	8710-1200	8710-1200B
XD Flex Relay/ACR / LVD	Yes	8810-1100	8810-1100B
XD Flex Relay/ACR / LVD	No	8810-1200	8810-1200B
XD Automatic Charging Relay ACR	Yes	8710-1300	8710-1300B



www.egismobile.com  
360.768.1211  
Bellingham, WA U.S.A





# XD Battery Disconnect - Competitor Comparison / Cross Reference



## Product Comparison Summary

Feature/Specification	XD Series ACR	ML-ACR
Universal 12/24 Control Voltage	Yes	No, 12 or 24 Vdc
Cover for Power Terminals	Included	No
Function & Cable Label Sheet	Included	Not Included
Local Status Led Indicator	Yes	No
Ability to Manually Lock On	Yes	No
Intuitive Manual Override	Yes	No
Terminal Stud Material	Stainless	Copper <sup>(2)</sup>
Simple Bottom Cable Entry	Yes	No <sup>(3)</sup>
Product Assemblies for 2-7 Relays	Yes <sup>(5)</sup>	No
Dust & Water IP Rating	IP67 / IP6K9K	IP66 <sup>(4)</sup>
Pressure Regulated Enclosure	Yes	No
Marine Grade Control Wiring	Yes	No
Mounting Footprint Width	66 <sup>(6)</sup>	95
Mounting Footprint Length	80 <sup>(6)</sup>	140
Mounting Depth	50	51.5
Standby Current Draw	1.2 mA	0 - 8 mA <sup>(1)</sup>
Max Continuous Current	500 A	500 A
Power Input Stud Size	M10 (3/8")	3/8" (M10)

(1) Excessive standby current drains batteries as no charge source is present potentially permanently damaging batteries and voiding battery warranties. The XD Series Standby current is 70% lower than the competitor's auto-release version, and so low (1.2 mA) that on its own would take 9 years to drain a Group 31 battery.

(2) Copper terminal studs in general are susceptible to thread damage if excessive assembly torque on the attachment nut is applied. The result is stripping of the threads and spinning of the nut; and a reduction or loss of clamping force between the cable terminal and device terminal. This can result in increased resistance and possibly overheating of the device and power cables.

(3) Studs parallel to the mounting surface require right angle cable terminal lugs to achieve bottom cable entry

(4) IP67 and IP6K9K are standard marine / harsh environment ingress performance levels to ensure effective long-term performance

(5) XD Series products are also available in single housing double and triple relay versions which provide significant cost, space, and standby current draw benefits versus existing industry options.

(6) XD Series mounting footprint is 60% smaller and much lighter, critical in today's systems with very limited space allocated for power management and where the affect of total system weight on vessel / vehicle performance has received greater attention.

## High Ampere Remote Battery Switches

Blue Sea Sys P/N	Vdc	Egis Mobile Electric P/N	Vdc	Manual Control	Control Leads	Control Method <sup>(1)</sup>
7700	12	8710-1500B	12/24	Yes	Wires	Bi-Stable
7700100	12	8810-1500B	12/24	Yes	DTM	Bi-Stable
7702	24	8710-1500B	12/24	Yes	Wires	Bi-Stable
7702100	24	8810-1500B	12/24	Yes	DTM	Bi-Stable
7713	12	8710-1500B	12/24	Yes	Wires	Auto-Release
7713100	12	8810-1500B	12/24	Yes	DTM	Auto-Release
7717	24	8710-1500B	12/24	Yes	Wires	Auto-Release
7717100	24	8810-1500B	12/24	Yes	DTM	Auto-Release

(1) Control Method Determined by Dip Switch Selection on Device

## High Ampere Solenoids

Blue Sea Sys P/N	Vdc	Egis Mobile Electric P/N	Vdc	Manual Control	Control Leads	Control Method <sup>(2)</sup>
7701	12	8710-1600B	12/24	No	Wires	Bi-Stable
7701100	12	8810-1600B	12/24	No	DTM	Bi-Stable
7703	24	8710-1600B	12/24	No	Wires	Bi-Stable
7703100	24	8810-1600B	12/24	No	DTM	Bi-Stable
7718	12	8710-1600B	12/24	No	Wires	Auto-Release
7718100	12	8810-1600B	12/24	No	DTM	Auto-Release
7719	24	8710-1600B	12/24	No	Wires	Auto-Release
7719100	24	8810-1600B	12/24	No	DTM	Auto-Release

(2) Control Method Determined by Dip Switch Selection on Device

## High Amp Automatic Charging Relays (ACRs)

Blue Sea Sys P/N	Vdc	Egis Mobile Electric P/N	Vdc	Manual Control	Control Leads
7620	12	8710-1400B	12/24	No	Wires
7620100	12	8810-1400B	12/24	No	DTM
7621	24	8710-1400B	12/24	No	Wires
7621100	24	8810-1400B	12/24	No	DTM
7622	12	8710-1300B	12/24	Yes	Wires
7622100	12	8810-1300B	12/24	Yes	DTM
7623	24	8710-1300B	12/24	Yes	Wires
7623100	24	8810-1300B	12/24	Yes	DTM

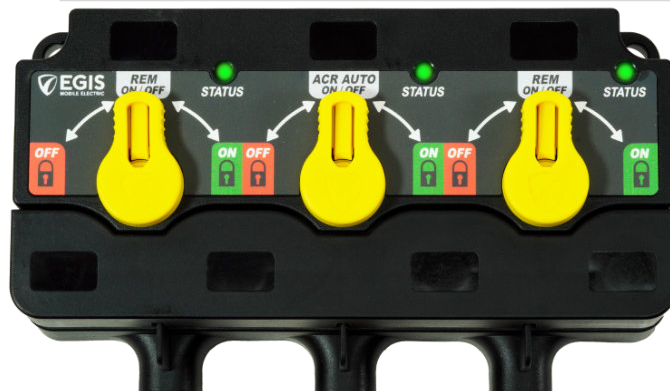

\* XD Series Dual and Triple Relays can be configured to have each individual internal relay replicate legacy competitor product functionality and connect with external controls with the same DTM connector and pin-out locations, simplifying product transition.